

## Triple Band

Static

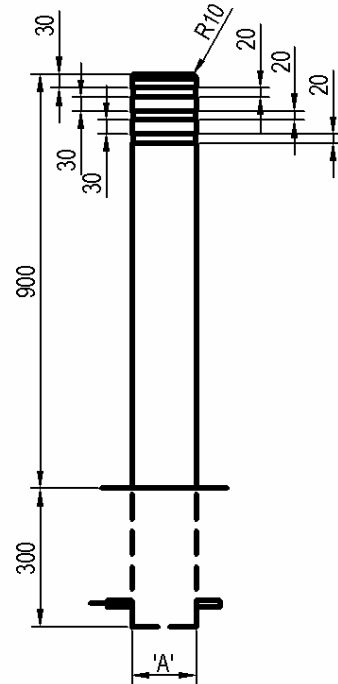

The Triple Band range features Three recessed 20mm wide bands.  
Optional adhesive reflector strip or painted band.

Mild Steel to BS 1449. Available in various diameters from 114mm to 193mm.  
Hot dipped galvanised to BSEN ISO 1461 (1999)  
Polyester Powder Coated 40-60 micron.

Mounting options: Static, Removable or Telescopic (Swing Lock)

Model	Name	Mounting	Dia 'A'	Galvanised	PPC	Dome Top	Data Sheet
USP025	TRIPLE BAND	Static	114mm	Yes	Option	Option	USP025.PDF
USP026	TRIPLE BAND	Static	139mm	Yes	Option	Option	USP026.PDF
USP027	TRIPLE BAND	Static	168mm	Yes	Option	Option	USP027.PDF
USP028	TRIPLE BAND	Static	193mm	Yes	Option	Option	USP028.PDF
USP029	TRIPLE BAND	Removable	114mm	Yes	Option	Option	USP029.PDF
USP030	TRIPLE BAND	Removable	139mm	Yes	Option	Option	USP030.PDF
USP031	TRIPLE BAND	Telescopic	90mm	Yes	Option	N/A	USP031.PDF
USP032	TRIPLE BAND	Telescopic	114mm	Yes	Option	N/A	USP032.PDF

Removable

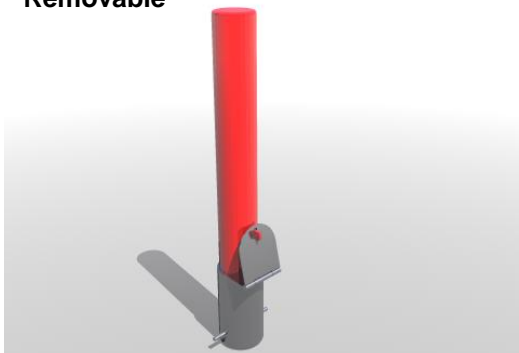

Telescopic  
(Swing Lock)

